

# Fitting Instructions

## Revo Transmission Mount Kit (MQB Chassis)

Fitting Difficulty



### Contents

Description	Qty
Revo Transmission Mount	1
Revo Battery Tray Bracket 1	1
Revo Battery Tray Bracket 2	1
Class 10.9 M12x1.5x55 Flange Bolt	3
Class 10.9 M10x1.5x45 Flange Bolt	4
Stainless Steel M10x1.5x40 Flat Head Socket Cap Screw	1
Stainless Steel M6x1.0 Nylon Lock Nut	2

### Recommended Tools

Tools	Size
Ratchet	N/A
Sockets	10,13,15,16,18,19
Hex Sockets	6
Torx Bits	T25
Constant Tension Clamp Pliers	N/A
Flat Head Screwdriver or Clip Pliers	Small/Medium
Hydraulic Jack	N/A
Block of Wood	2x4 or equivalent thickness



Before starting, please ensure that the battery is disconnected and you have ensured the engine is cool. Engine temperatures can remain high for a substantial amount of time after use.

# Fitting Instructions

## Revo Transmission Mount Kit (MQB Chassis)

Fitting Difficulty



Installation was performed on a DSG MK7 GTI. Installation on other vehicles will be similar but may not be exact

- 1 Securely raise the vehicle on a lift or jack stands to allow access to the underside of the vehicle
- 2 Remove the eight T25 Torx screws that secure the splash pan to the plastic wheel surrounds and the bottom of the bumper

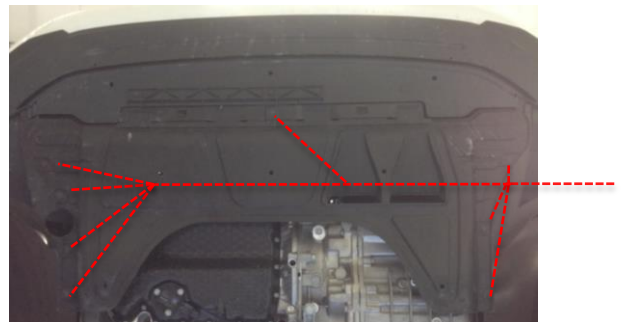

- 3 Support the transmission using a hydraulic jack or jack stand. Place a block of wood between the transmission case and the jack/jack stand. Take care when performing this step; the cast transmission case can crack easily



- 4 Open the hood and unplug the secondary air injection pump connector (if equipped) by depressing the two side tabs and pulling away from the intake lid. Also unplug the small vacuum hose by firmly pulling the hose away from the intake lid

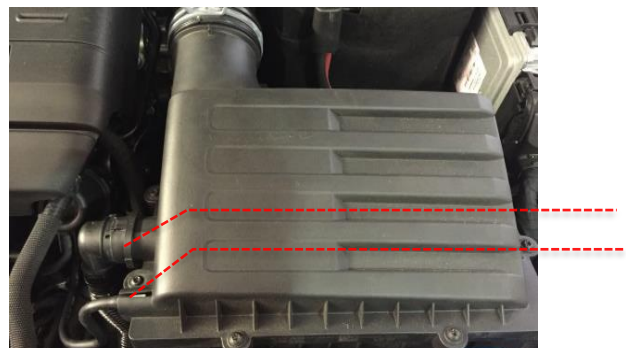

## Fitting Instructions

### Revo Transmission Mount Kit (MQB Chassis)

Fitting Difficulty



- 5 Using constant tension clamp pliers loosen the constant tension clamp on the intake hose and disconnect it from the OE intake lid. Firmly pull the OE intake lid/box up to disconnect the rubber grommets. Set the intake box aside, out of the work area

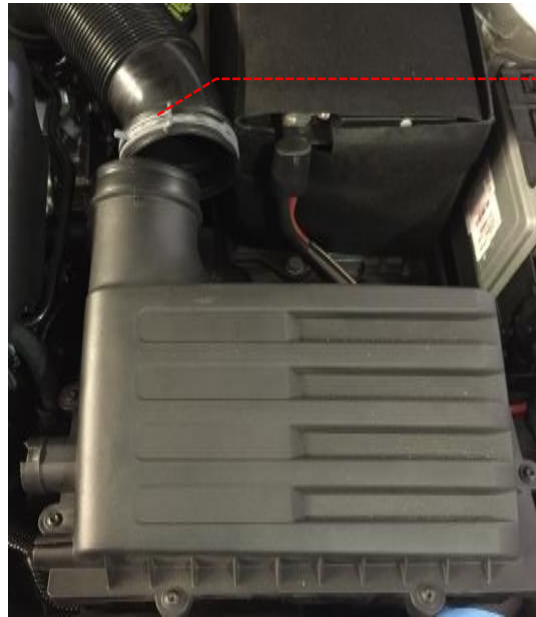

- 6 Using a 10mm and 13mm sockets, disconnect the battery cables and unbolt the battery tie-down. Remove the battery and set it aside, out of the work area

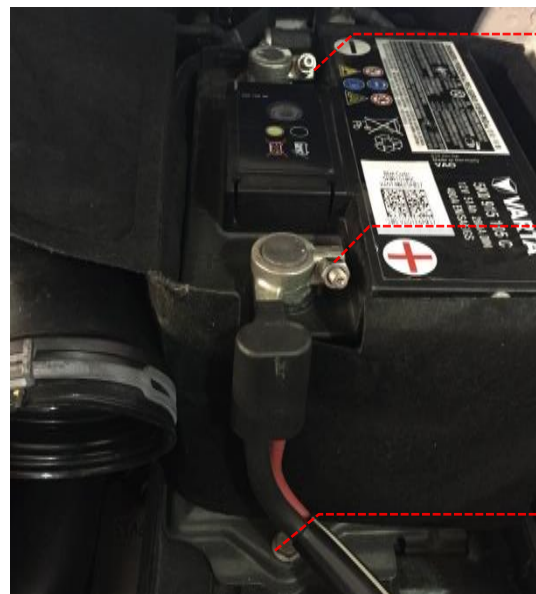

## Fitting Instructions

### Revo Transmission Mount Kit (MQB Chassis)

Fitting Difficulty



- 7 Using a 10mm socket, remove the three bolts and one nut that fixture the battery tray. Unclip the three wiring clips and remove the battery tray. Set it aside, out of the work area

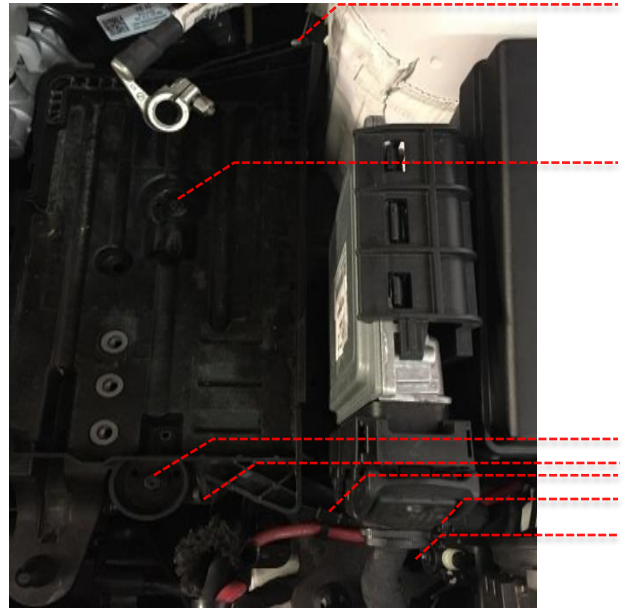

- 8 Unclip the ECU by gently pulling the plastic tabs back. Carefully set it towards the headlight. Do not disconnect the ECU electrical connectors



- 9 Using a 10mm socket, remove the two nuts fixturing the ECU holder. Remove the holder and set it aside, out of the work area

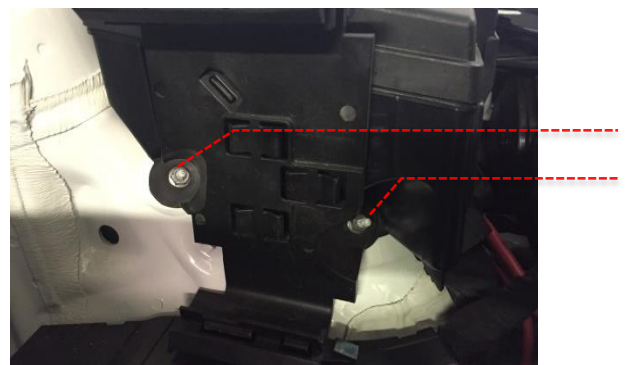

## Fitting Instructions

### Revo Transmission Mount Kit (MQB Chassis)

Fitting Difficulty



- 10 Using a flat-head screwdriver or clip pliers, disconnect the wiring harness cover at the four points. Disconnect the seven wiring clips. Carefully move the loom and cover towards the wheel, exposing the transmission mount and four chassis bolts

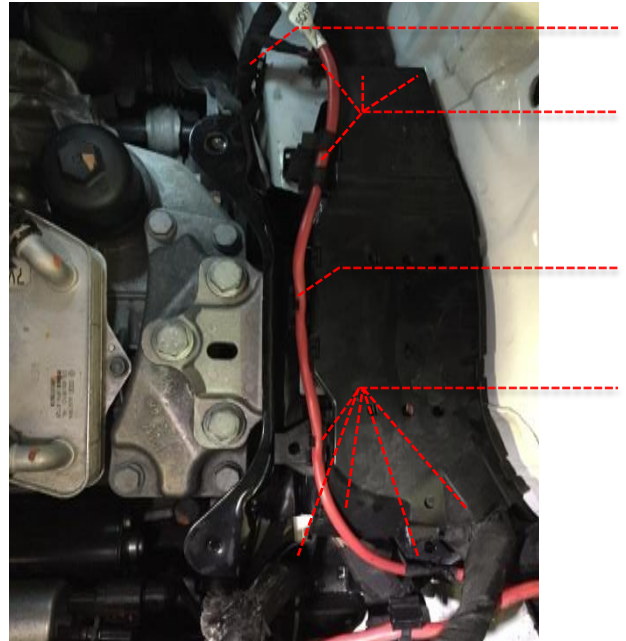

- 11 Using 16mm and 18mm sockets, remove all seven bolts from the OE mount. Remove the OE transmission mount and set it aside, out of the work area

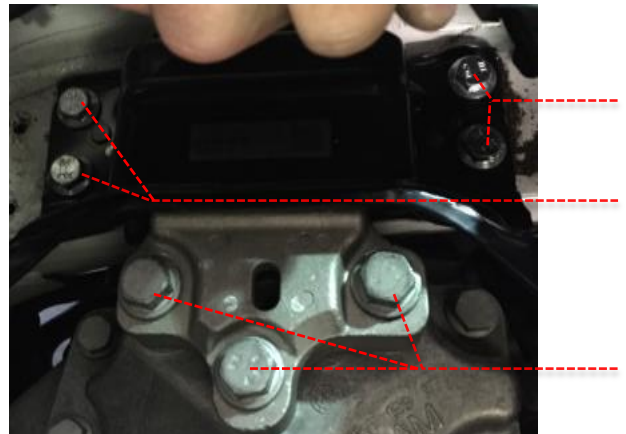

- 12 Check the pre-assembled Revo mount to ensure the arm can rotate within the bushings

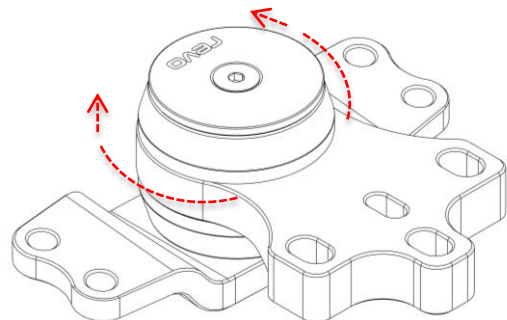

## Fitting Instructions

Fitting Difficulty



### Revo Transmission Mount Kit (MQB Chassis)

---

- 13 Check the pre-assembled Revo mount and be sure the lower bushing flat face is oriented as shown

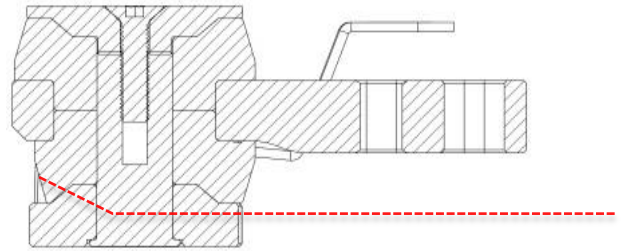

- 14 Install the Revo mount into the cavity. Be sure the alignment dowels on the Revo base insert fully into the chassis

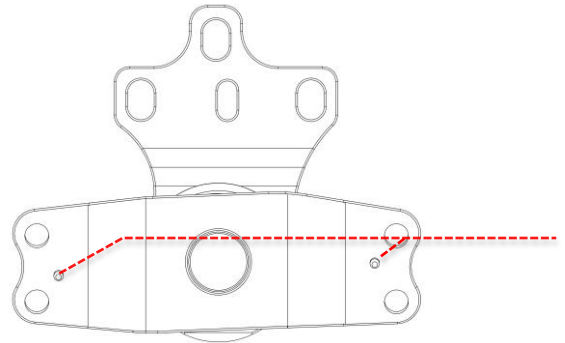

- 15 Loosely install both Revo battery tray brackets and all seven provided bolts. Align the battery tray brackets to the edges of the Revo mount base. The contours of the base and bracket should match up as shown. Using a 15mm socket, tighten all four chassis bolts to 34 ft.-lbs. (46Nm) ensuring the brackets do not shift or move while tightening the bolts

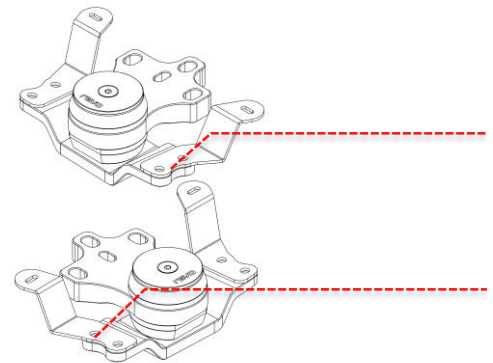



## Fitting Instructions

Fitting Difficulty



### Revo Transmission Mount Kit (MQB Chassis)

- 16 Align the Revo mount arm as shown. Be sure the faces highlighted are parallel and the mount arm is aligned with the OE transmission bracket hole as shown. Using a 19mm socket, tighten the three transmission mount bolts to 44 ft.-lbs. (60Nm). Be sure that the Revo mount arm does not shift or move while tightening the bolts



- 17 Using a 6mm hex, torque the flat-head socket cap screw to 27 ft.-lbs. (34Nm)



Be sure to install thread locker onto the flat-head socket cap screw before installation, as shown

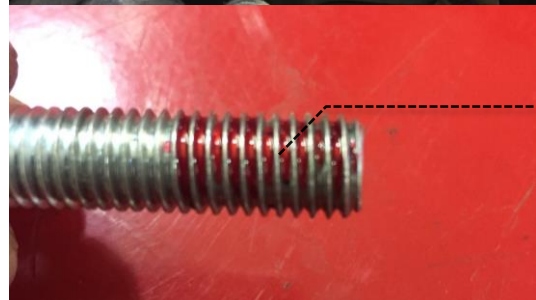

- 18 Reinstall all remaining OE parts that were removed earlier. Reinstallation is done in the reverse of removal. When installing the battery tray, use the provided flange locknuts with the two OE bolts that insert through the Revo battery tray brackets. Ensure all bolts are tightened to factory torque specifications. Check over the installation, making sure everything is secure before test driving. The installation is now complete. GO PLAY!